

ISOFLEX MOUNT DATA SHEET - M85

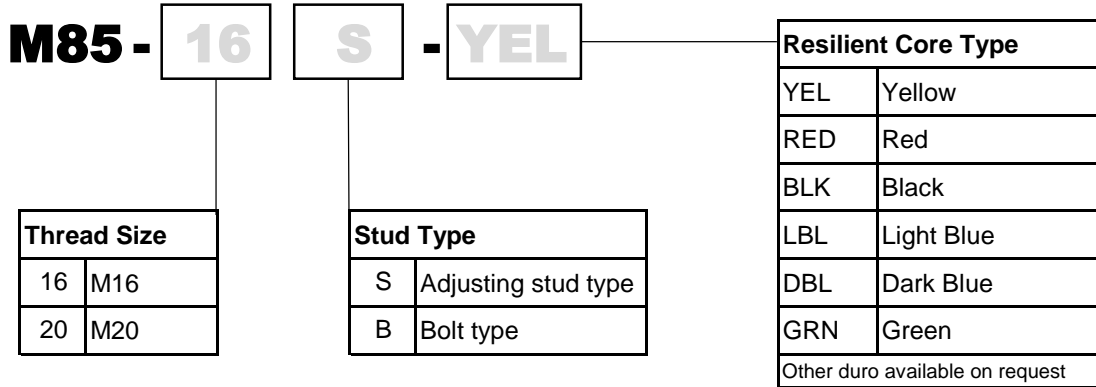

Base: Black - 75 SDH-D

Metal components a combination of marine alloy, stainless steel and components zinc plated to ASTM B633 Type II SC3



Mount model M85-16S or M85-20S

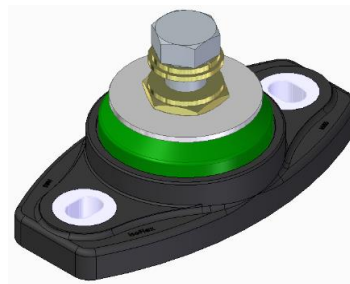

Mount model M85-16B or M85-20B

WEIGHT:

Model	Metric (kg)	Imperial (lb)
M85-16S	1.2	2.6
M85-20S	1.3	2.9
M85-16B	1.2	2.6
M85-20B	1.6	3.5

SPECIFICATION:

	Metric (kg)	Imperial (lb)
Recommended working load per mount	75-300	165-660

ISOFLEX MOUNT DATA SHEET - M85

COMMON DIMENSIONS :

	Metric (mm)	Imperial (in)
Base length	190	7.48
Base width	98	3.86
Base bolt centres	140	5.51
Base thickness	20	0.79
Base bolt size	M12	1/2

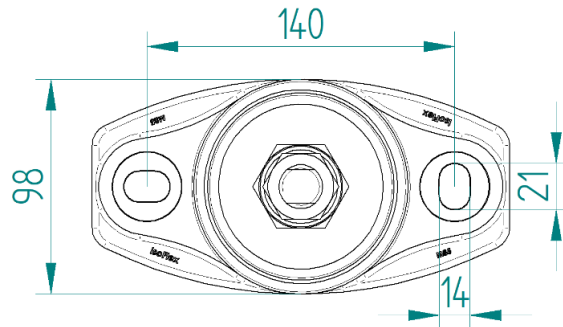

MODEL SPECIFIC DIMENSIONS :

Model	Overall Height (H)		Min Free Height (J)		Height Adjustment (J)	
	(mm)	(in)	(mm)	(in)	(mm)	(in)
M85-16S	140	5.51	86	3.39	10	0.39
M85-20S	160	6.30	92	3.62	10	0.39
M85-16B	-	-	62	2.44	-	-
M85-20B	-	-	62	2.44	-	-

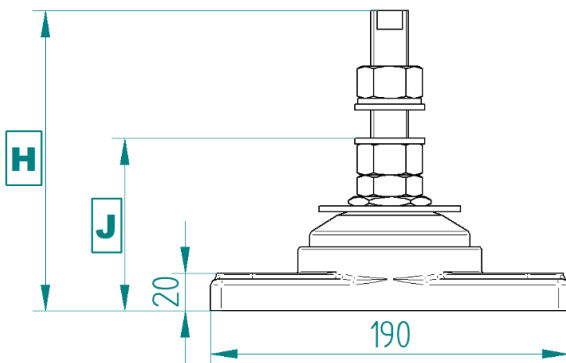

Mount model M85-16S or M85-20S

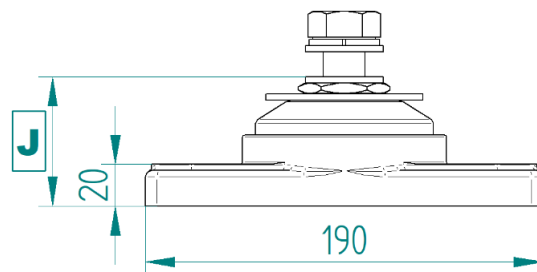

Mount model M85-16B or M85-20B

ISOFLEX MOUNT DATA SHEET - M85

Loading Type: Axial - Vertical Down (A-direction)

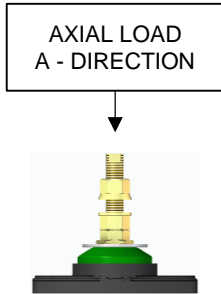

Resilient Core Colour	Spring Rate at 2mm	
	(kg/cm)	(lb/in)
Yellow	235	1315
Red	360	2015
Black	640	3585
Light Blue	840	4705
Dark Blue	980	5490
Green	1155	6470

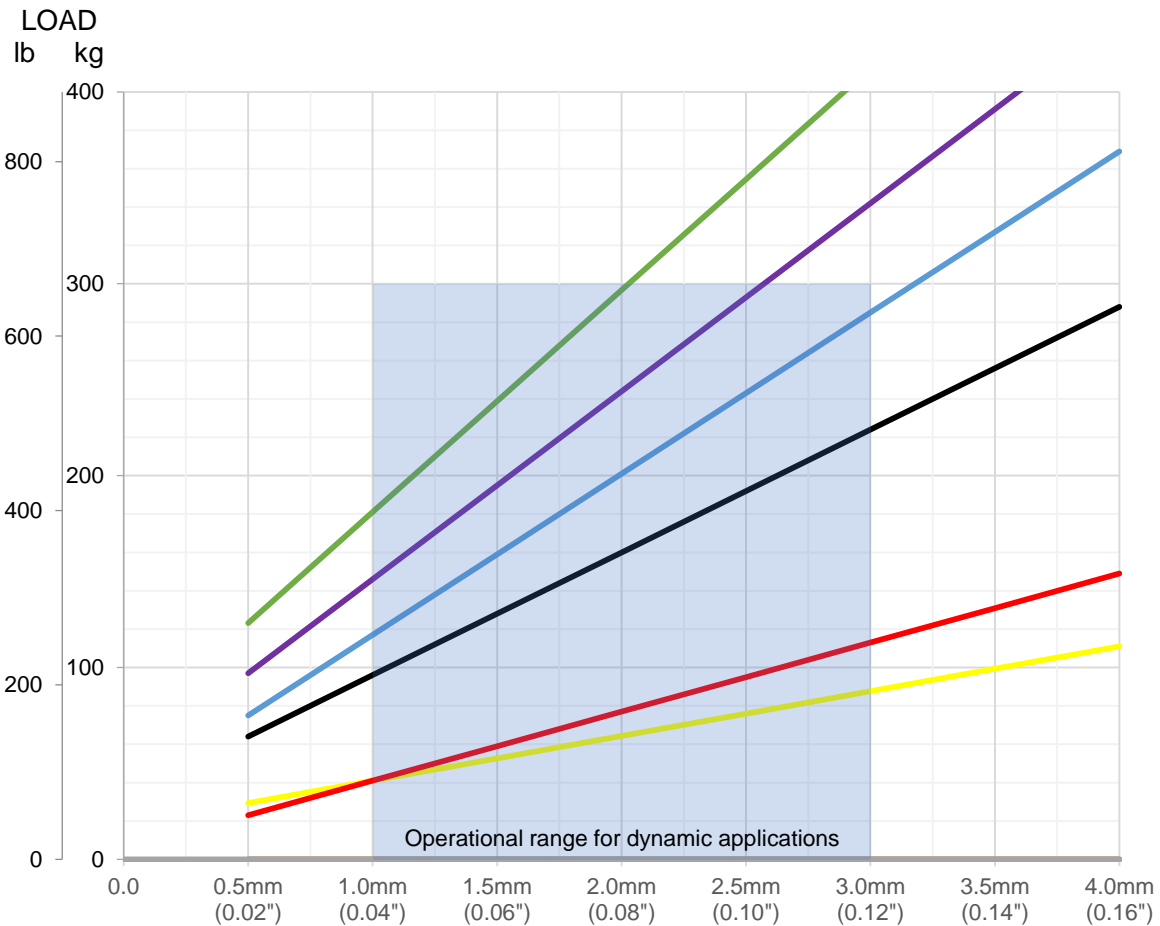

Graph: Static Axial Vertical Load [kg] (lb) versus Deflection [mm] (in)

ISOFLEX MOUNT DATA SHEET - M85

Loading Type: Longitudinal Thrust (T-direction)

LONGITUDINAL THRUST
T - DIRECTION

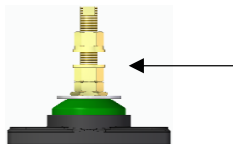

Resilient Core Colour	Spring Rate at 2mm	
	(kg/cm)	(lb/in)
Yellow	1960	10975
Red	2000	11200
Black	2085	11675
Light Blue	2250	12600
Dark Blue	2290	12825
Green	2335	13075

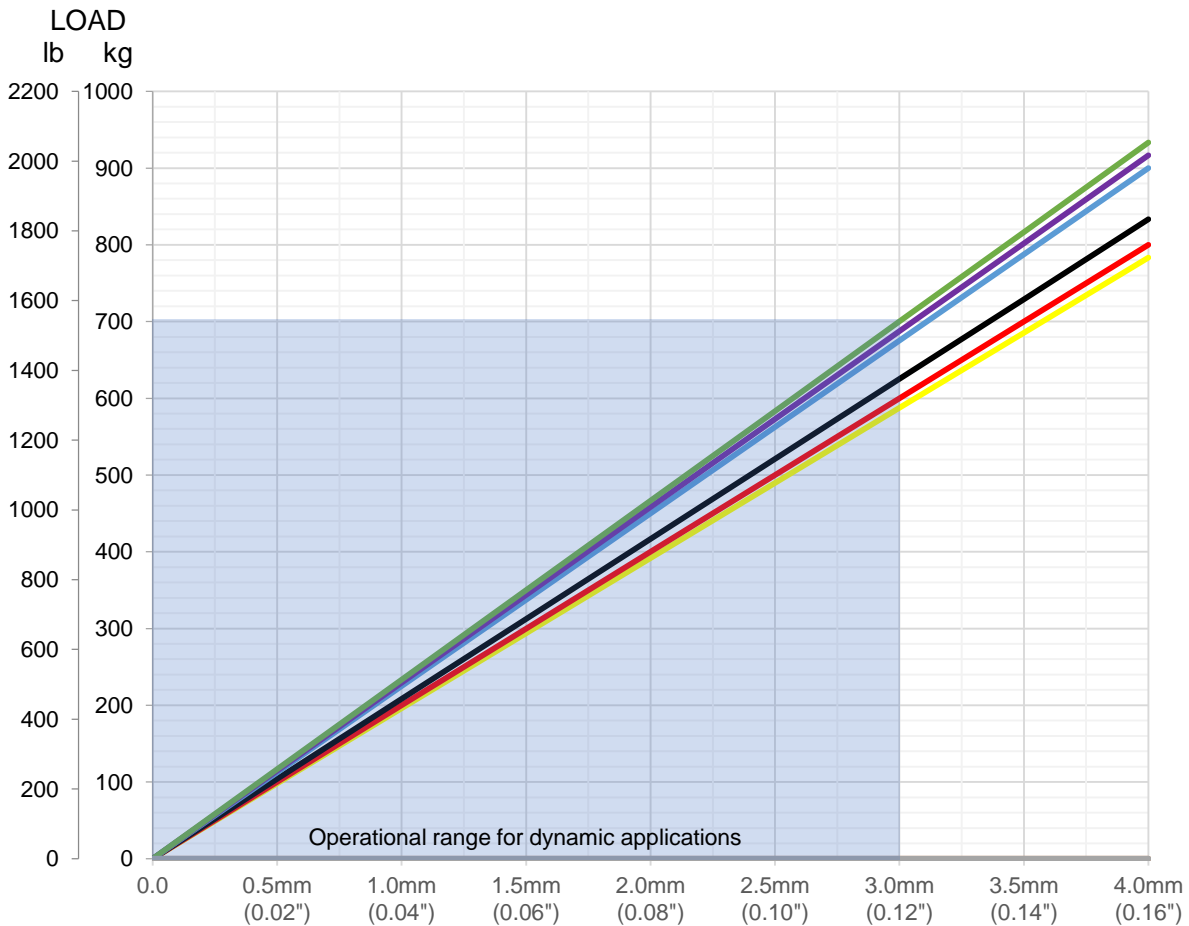

Graph: Static Longitudinal Load [kg] (lb) versus Deflection [mm] (in)

Note: Stated spring rate with 2.5mm axial compression simulation load

ISOFLEX MOUNT DATA SHEET - M85

Loading Type: Lateral (L-direction)

LATERAL LOAD
L - DIRECTION

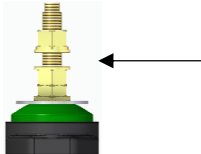

Resilient Core Colour	Spring Rate at 2mm	
	(kg/cm)	(lb/in)
Yellow	1540	8625
Red	1585	8875
Black	1665	9325
Light Blue	1835	10275
Dark Blue	1875	10500
Green	1915	10725

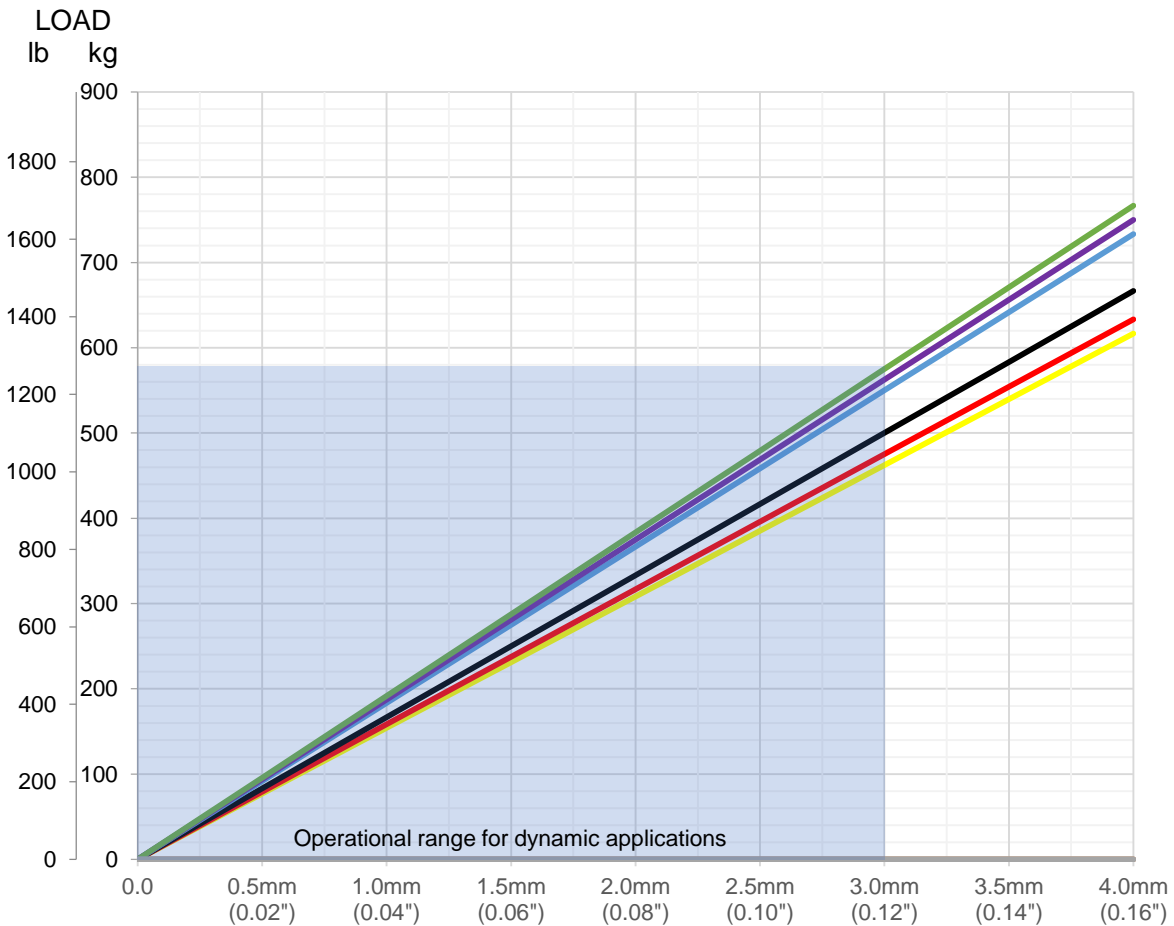

Graph: Static Lateral Load [kg] (lb) versus Deflection [mm] (in)

Note: Stated spring rate with 2.5mm axial compression simulation load